



Casual sanitary ware



Shower bathroom (GS167)

GYH-9090N, GYH-9090HN, GYH-1010N, GYH-1212N,
GYH-1209N, GYH-1180N, GYH-112N

The products are made according to ISO-9001 and the standard for electrician safety

★ Noted : The instructions are only for your reference. Please contact supplier for further information.

MANUAL

Note

Dear user,

Thank you for your choosing GL series of computerized steaming bathroom, which are controlled by modern full function computer and using beautiful bronze metal parts. It sources from personality and unique for people.

Please read carefully this consumer manual before installation and operation to ensure that you can use this product safely.

Warning:

- 1.The electrical installation of this product must be made by qualified electrician.
- 2.The local electrical parameters must be accord with electric parameters of this product.
- 3.This product must be grounded properly and tested.
- 4.There is no parts of the computer control which can be repaired by user themselves, do not unpack the computer control yourselves if the electrical parts of this product do not work. You should inform the dealer to check and repair it. Our Company would not be liable for the electrical parts otherwise user unpack the computer control themselves.
- 5.This manual is owned by end user.

Contents

Steaming Bathroom Features and Parameters	1
Installation	2-4
Operation	5-7
Maintenance	8
Trouble Shooting	20

Trouble Shooting

Symptoms	Problem Causes	Recommended Action
No power to the shower room	1. General power plug connects to the electrical outlet or damaging wiring. 2. There is creepage on the circuit cause the GFCI trips.	1. Connect the plug to the electrical outlet properly, or check and replace the wiring. 2. Check the circuit and repair it.
The control system automatically shuts down after starting	1. Control connects loose to the electrical outlet. 2.the 4A fuse is burn-up.	1. Plug the connector into the electrical outlet tightly. 2.repair the fuse.
The top lamp,or background light does not work	1. The lamp or light is damaged. 2.the wire does not connect correctly. 3.no power output from the control box.	1. Replace the lamp, light. 2.connect the wire correctly(if the top lamp wire connect to the background light will damage the background light). 3.check the main board in the control box.
Exhaust fan does not work	1. Exhaust fan does not work. 2.exhanst fan disconnect.	1. Replace the exhaust fan. 2. Connect the wire correctly.
Radio effect is not good enough	1.Antenna is not spread. 2.Antenna position is not proper.	1.Spread antenna. 2.Adjust antenna position.

Notice:1. Call dealer or qualified electrician for maintenance when meeting problems.
2. Must not replace, put on or take off the electrical parts when checking problems by user themselves.

Maintenance

- 1.Keep the acryl surface of the shower bathroom from crashing by a sharp edge. If the surface is crashed or there is some blot which can not be removed by scrub, using #1500 sand paper to polish it and apply some toothpaste on a soft cloth to wipe it.
- 2.Using special cleanser to clean-up the shower bathroom. The cleanser contain no such organic solvents as acid, alkali, ketone and aldehyde.
- 3.Need not polish the plating parts of the shower bathroom to prevent from affecting the brightness of the surface. Keep benzine and acid (such as sealant) away from the plating parts avoid eroding when being in installation.
- 4.Shut down the water and electrical supply if the shower bathroom is not in operation for a long time. Keep it in a dry and ventilated circumstance and far away from volatile chemicals.
- 5.Clean-up the filter at the joint of the water pipe to ensure the fluent flowing.

Steaming Bathroom Feature and Parameters

1.Model,specification and function of shower bathroom.

Model	Size (cm)	Standard Configuration									
		FM Radio	With Tray	Roof Lamp	Ventilation Fan	Top Shower	Flexible Sliding Shower	Sole Massage Device	Seat	Background light	Speaker
GYH - 9090S	90×90×220	●	●	●	●	●	●	●	●	●	●
GYH - 1010S	100×100×220	●	●	●	●	●	●	●	●	●	●
GYH - 1212S	120×120×220	●	●	●	●	●	●	●	●	●	●
GYH - 1180S	110×80×220	●	●	●	●	●	●	●	●	●	●
GYH - 1209S	120×90×220	●	●	●	●	●	●	●	●	●	●
GYH - 112B	120×120×220	●	●	●	●	●	●	●	●	●	●
GYH - 9090H	90×90×220	●	●	●	●	●	●	●	●	●	●

2.Water and electric technical parameters of shower bathroom.

Power Parameters				Water Supply Parameters			Diameter Of the Pipe Joint	
Voltage	Frequency	Control Voltage	Lamp Power	Water Supply Pressure	Working Pressure	Water Flow Volume	Cool&Hot Water Supply	Drainage
AC220V	50HZ/60HZ	DC12V	13W	≥ 0. 2MPa	0. 2-0. 4MPa	8-10L /min	Φ15	Φ40

3.Water and electric installation. (unit: mm)

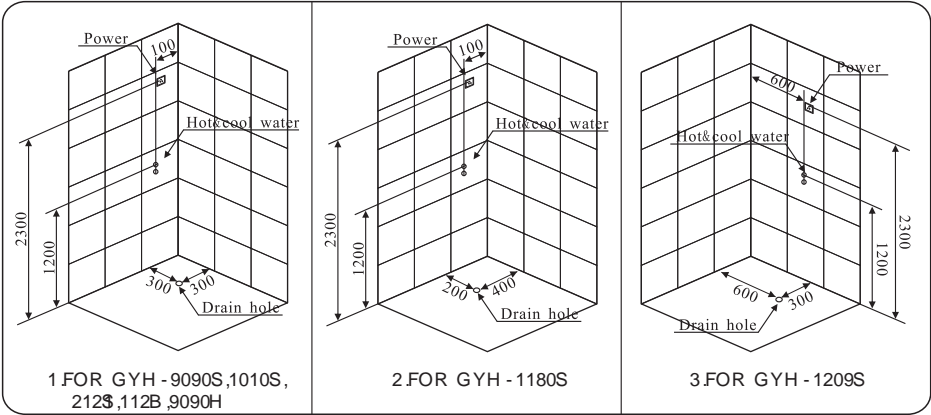

Installation

1. Tools

- ① “+” shape screwdriver, “-” shape screwdriver ② electric drill ③ stepladder
④ adjustable wrench ⑤ pencil ⑥ measure ruler ⑦ gradienter

2. Installation diagram

2.1 For GYH -1180S :

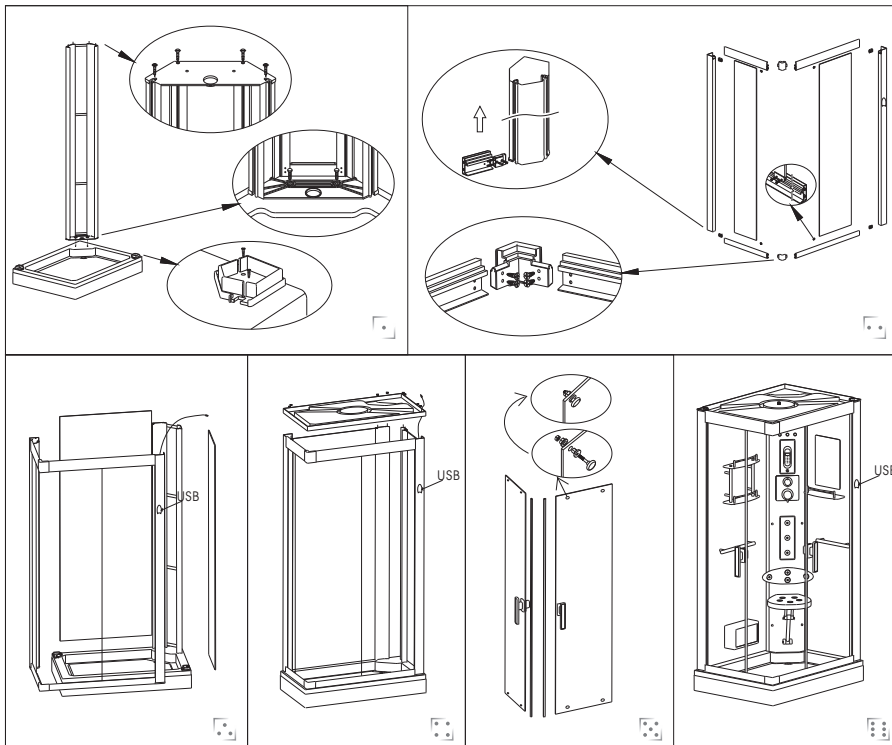

2. Operation of whirlpool massage.(this function is not included if the bathroom without whirlpool bathtub.)

Push air break switch to turn on the water pump for whirlpool massage, you can turn air adjuster for comfortable water pressure. Push air break switch again turn off the pump.(air break switch and air adjuster are all installed on the bathtub surface).

3. Operation of control panel and remote control (GL-05A control system)

- 3.1 Connect the plug to the electrical outlet, the bathroom collocates a plug protected by Ground-Fault-Interrupter(GFCI), press power button, the system would be standby, the indicator light display green, make sure the GFCI is effective by pressing the test button before using the bathroom.

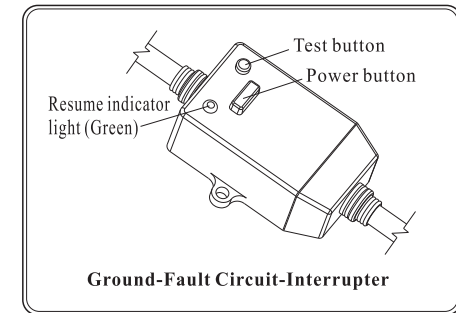

If your purchase steaming bathroom is configured thermal faucet, you could:

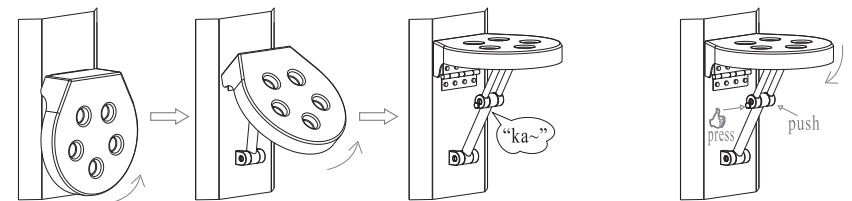

- Adjust the water temperature for bathing: turn the temperature adjuster according the sign on the panel, when the handle point at 38℃, the handle will be locked, if you need to turn the temperature up continue, you should press the handle and turn the handle point at high temperature.
- Adjust the water flow volume: turn the water flow volume adjuster.
- Choose the function which you desire: turn the variety flow valve, make the handle point at the function sign which you desire.



1. Ready mode

After power on the system in standby state, the display area displays a red dot tip has been switched on

2. Switch on/off

Under the standby mode, press the key  about 0.5 second, the system switch on, display ---, light open. Press the key  0.5 seconds, the system switch off.

3. Light

At system startup mode, press the key  to open the lights. Press first time, the top lamp and the background lamp are on, press the second time, both of top lamp and background lamp off.

4. Volume

In radio mode, press the panel **Vol+** or **Vol-**, decrease or adjust for the volume, the volume of the display shows the front current. Can adjust between 0-15 db.

5. Fan

Under the open system, according to the panel  button to open the fan, fan red light is on. Press this button again, the fan is off, light also is off.

6. Bluetooth

1. Open the bluetooth function: on and connected to the mobile phone bluetooth, press by touch  key change in the radio to the bluetooth music; Change again touch closed bluetooth and radio function.

2. Change the song: touch the key cut into the state of song, digital tube display, this time by adjusting the + and - key switch songs.

3. The volume adjustment: in bluetooth regular or touch panel button to enter the volume adjustment state adjustable radio volume, the adjusting range of 0 ~ 15, adjust the display shows such as; Volume can be continuous button.

4. System shutdown automatically disconnect bluetooth connection 10 seconds. 10 seconds after the reboot to connect bluetooth mobile phone, cell phone music player at the same time, the state of play. Bluetooth to normal operation after successfully in synchronous control. In the process of the bluetooth pairing need password "0000"; Bluetooth device name "CAR MUSIC".

2.2 For GYH -9090S / 9090H / 1010S / 1010H / 1212S:

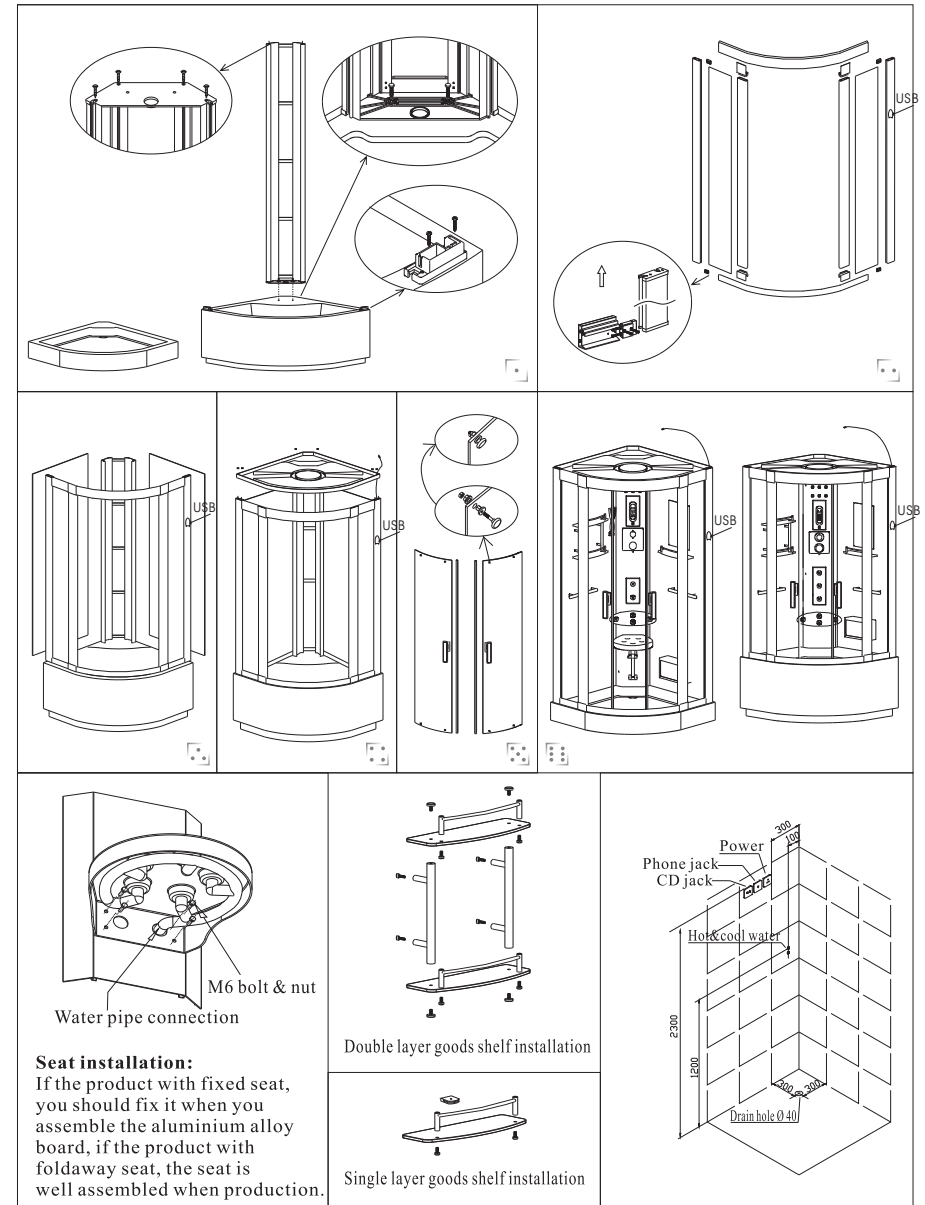

Operation

1. Operation of variety flow valve

Turn on the general valve of water supply, pull up the wrench valve to make the water overflow and turn it to adjust the water temperature. when the water temperature is steady, turn the variety flow valve to select function according to your desire including foot massage, overflow from portable shower head, fixed top shower head, faucet of the bathtub.

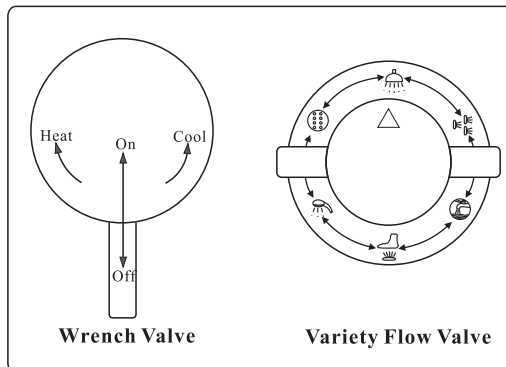

Casual Sanitary Wares

2.3 For GYH-1209:

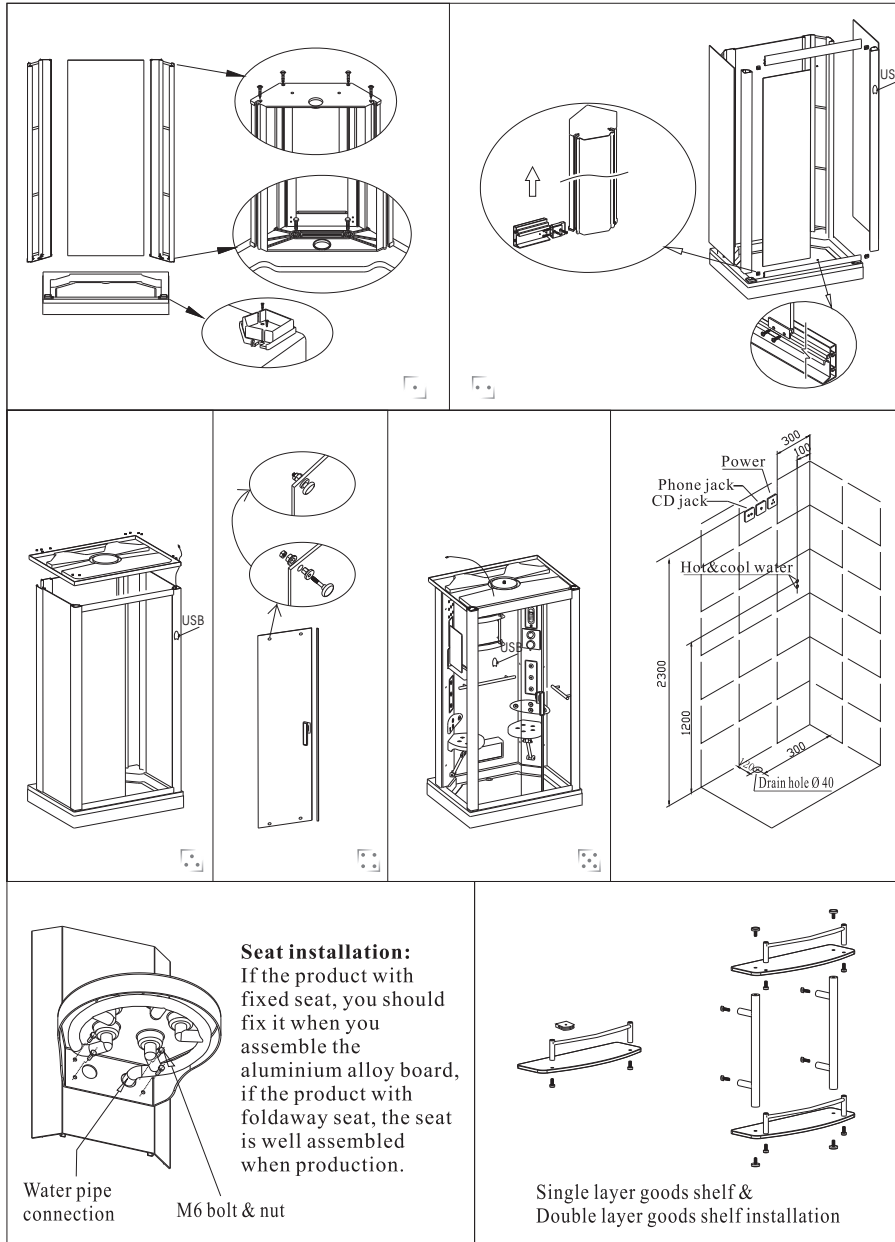

3. Water connection

- ◆ Connect the top shower from variety flow valve (caution the marks on the pipe end), then take the aluminium alloy board into bathroom, connect all functions refer to the marks on the pipe end.
- ◆ Connect the hot & cool water supply hose to indoor prepared tie-in, caution which is hot water or cool water.

Notice: To cut off the water supply easily after finishing your bath anytime, please place a general water valve between the supply outlet and bathroom inlet on a easy-operated place.

Diagram of water supply

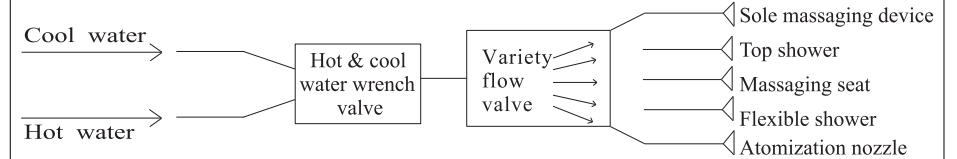

Operation procedure for control

一、Use the information

1. This panel processing was optimized by using a splash of water, when detect wrong operation (touch two or more than two keys at the same time), the system does not respond, at this time to wait for about 1 second to restore operation.

2. 25 seconds without operation, panel lock, touch panel, the system does not respond, Showed **LOC**, should touch panel key unlocked, prompt **ULC** to operation panel all key at this time.

3. Through panel touch-key operation, if the system effective operation, each "du" of the operating system will be prompt.

Diagram of control panel

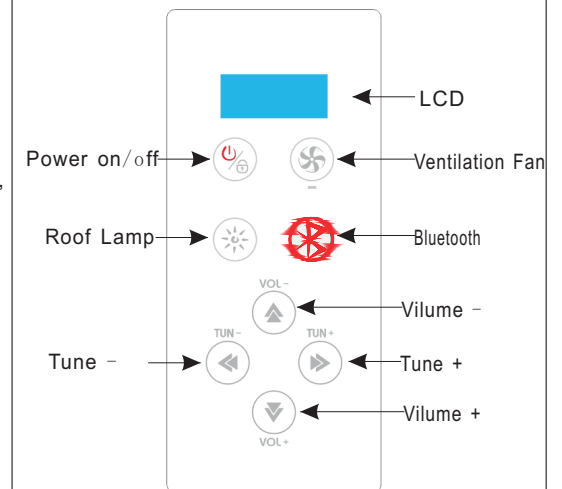

Control Panel